

D12D-B MP, D12D-D MP

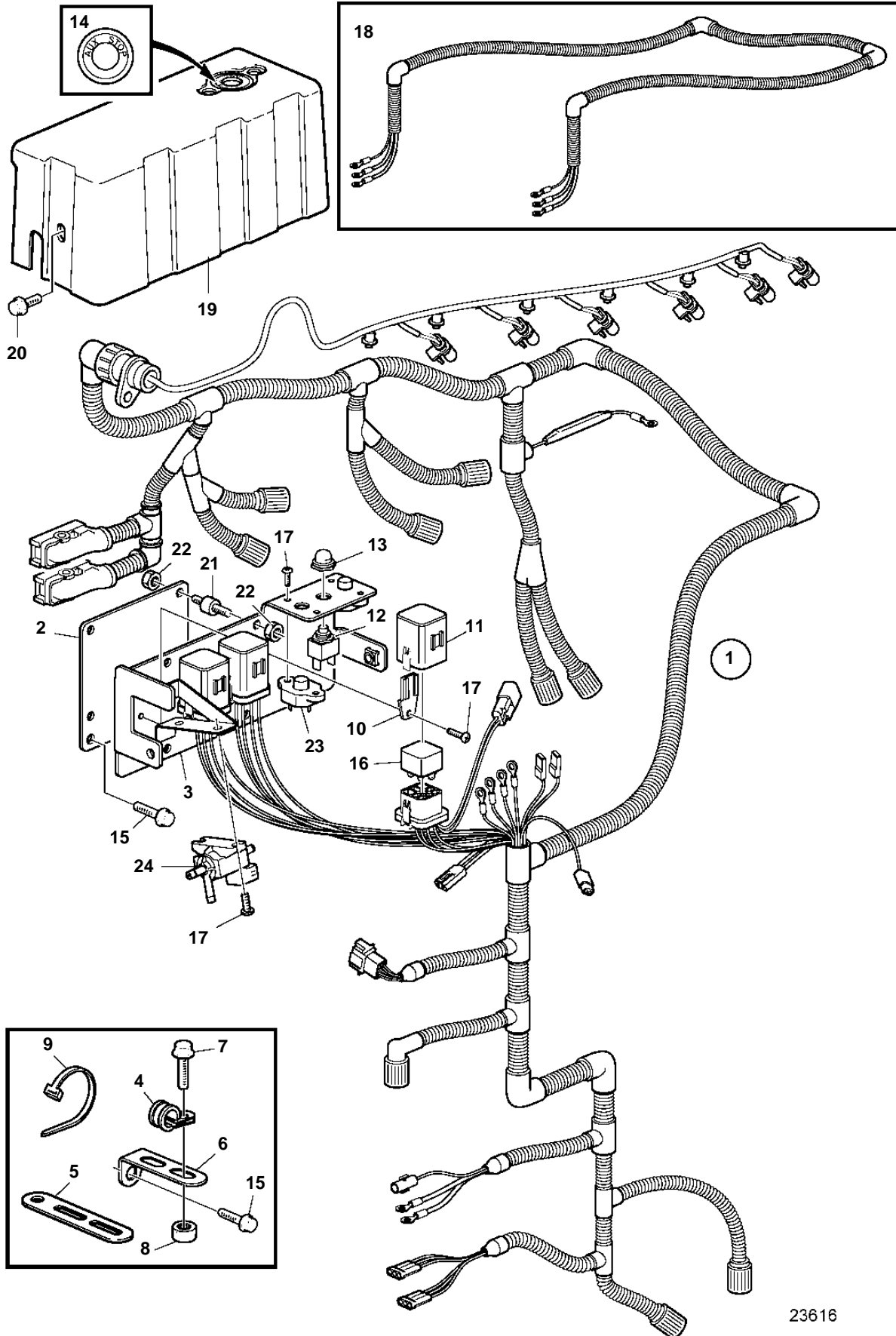

23616

D12D-B MP, D12D-D MP

REF	PART NO.	QTY	DESCRIPTION	NOTES
1	3842703	1	Wiring harness	
2	3817971	1	Bracket	
3	3842686	1	Fuse holder	
4	949746	3	Clamp	I.D=12,7mm
	949747	1	Clamp	I.D=15.7mm
	947827	9	Clamp	I.D=25,4mm
5	965543	1	Bracket	
6	965559	7	Bracket	L=80mm
	965562	2	Bracket	L=110mm
7	946440	X	Flange screw	
8	945408	X	Flange nut	
9	983472	X	Cable tie	L=148mm
	948211	X	Cable tie	
10	3587174	3	Relay retainer	
11	3587173	3	Relay box	
12	873959	1	Breaker	
13	828586	1	Nut	
14	3809463	1	Decal	
15	946441	5	Flange screw	
16	20374662	3	Relay	
17	969407	9	6 point socket screw	
18	3808666	1	Wiring harness	
19	3812769	1	Cover panel	
20	946440	2	Flange screw	
21	1348141	4	Absorber	
22	945407	8	Flange nut	
23	873952	2	Automatic fuse	
24	3819161	1	Solenoid valve	